



www.esbe.se



SERIES CRA110



NO.1 IN HYDRONIC SYSTEM CONTROL



Series CRA111  
Series CRA112

CE  
LVD 2006/95/EC  
EMC 2004/108/EC  
RoHS 2002/95/EEC

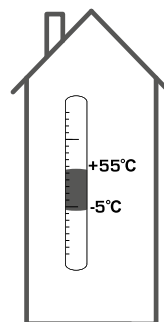

Mtrl.nr. 9814 03 90 • Ritn.nr. 9210 utg. B • Rev. 1012

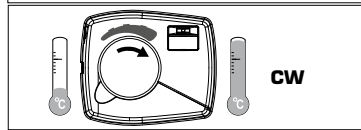
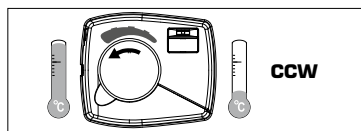
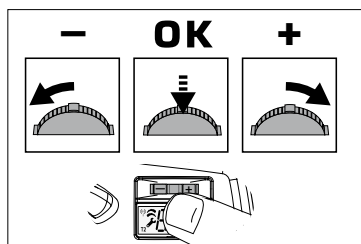

1

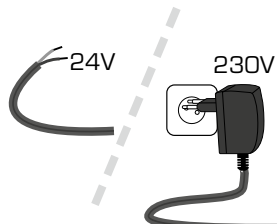

=



=



=

2

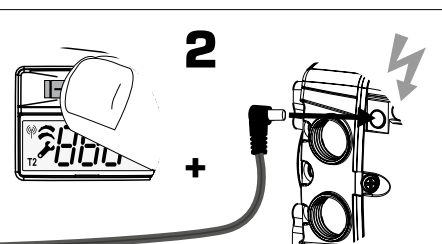

+



+



+



1

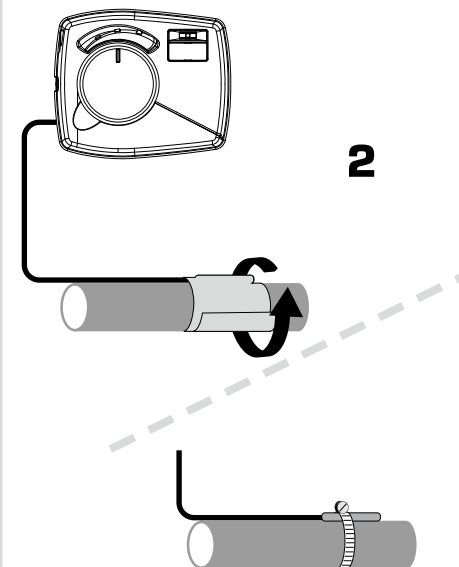
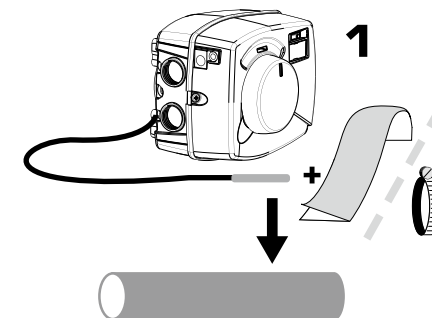



▲ = MAX

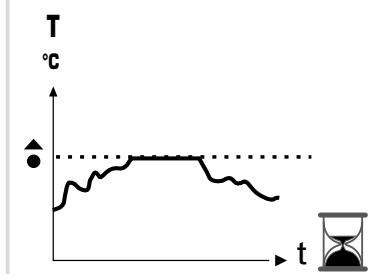
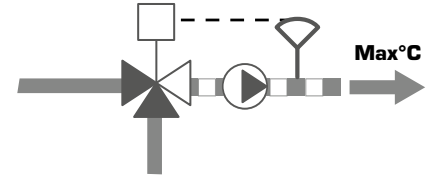

	50 °C
	~40 - 50 °C
	~60 - 80 °C
	60 °C

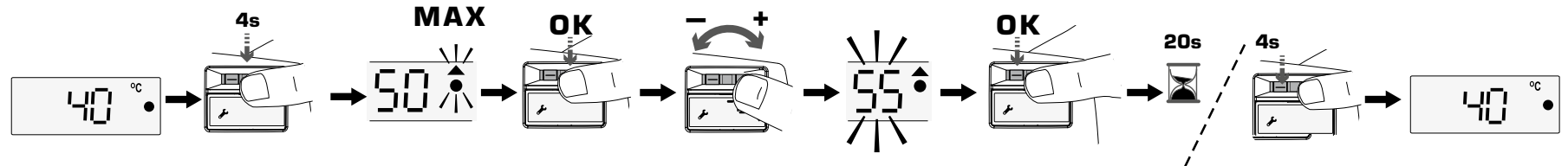

▼ = MIN

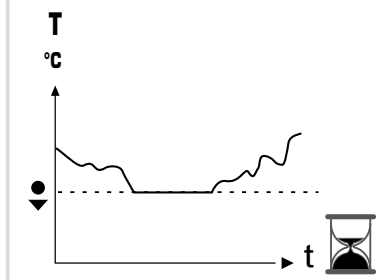
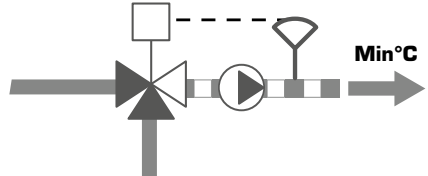

	5 °C
	~5 - 25 °C
	~5 - 25 °C
	~5 - 25 °C

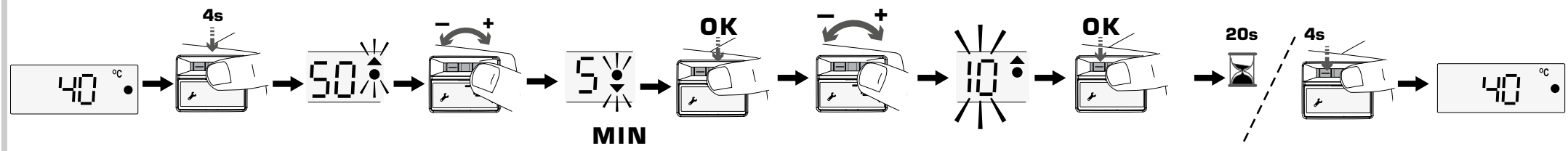

# 5 T

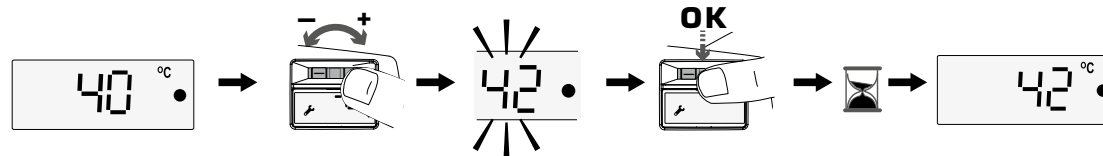
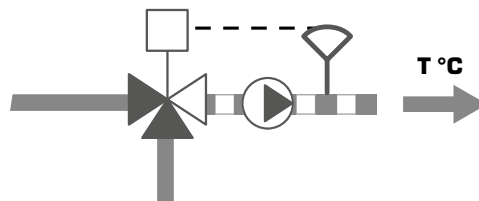
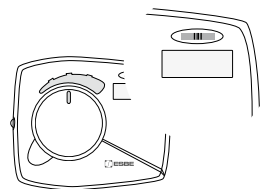

# 6 T2

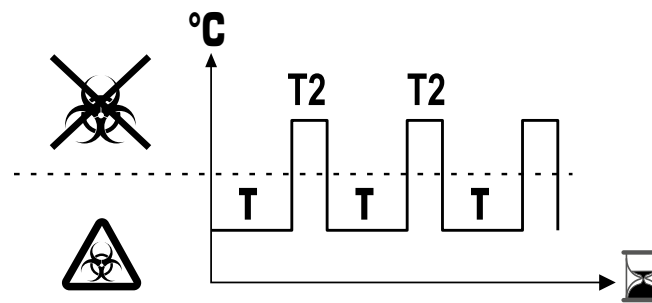
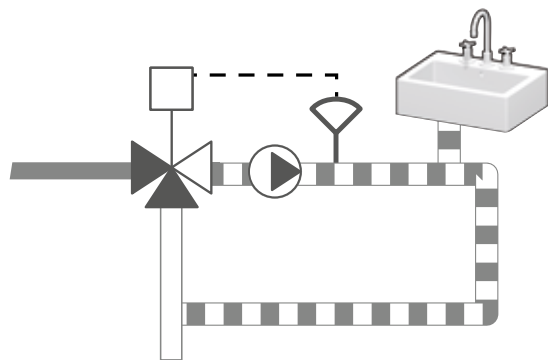

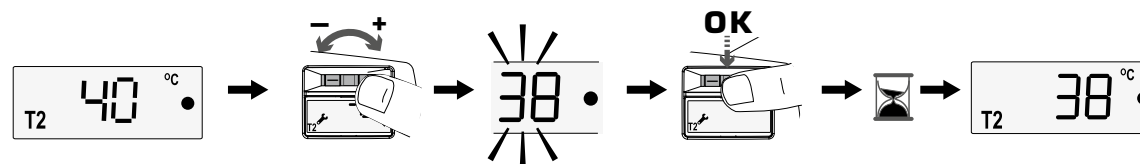
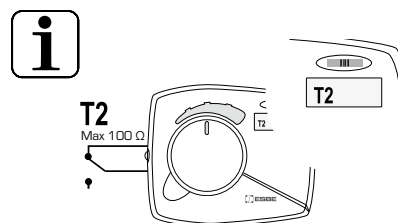
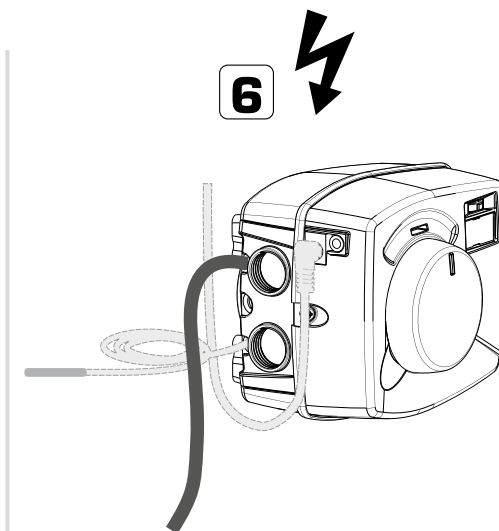
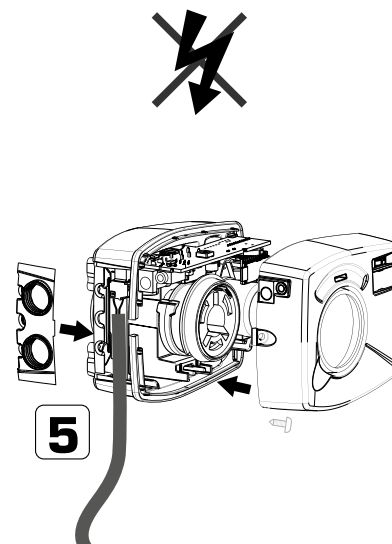
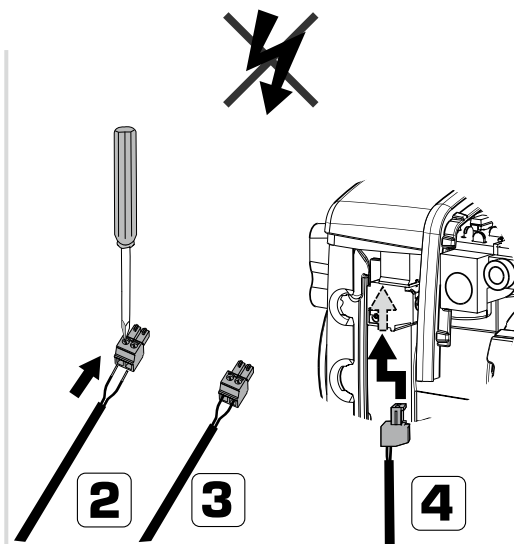
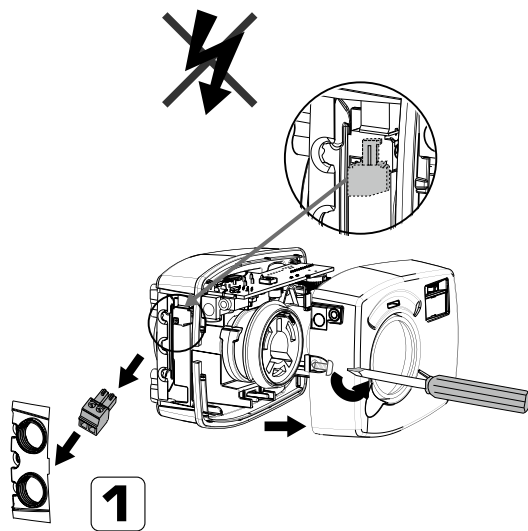

T

